

NO	QTY	PART NO	DESCRIPTION	SEAL KIT
1	2	21500316	SCREW, SET, CUP PT, M3 X .5 X 8	
2	2	23050031	RING, RTNG, EXT, 0.197	X
3	4	23050032	RING, RTNG, EXT, 0.236	X
4	2	39051079	O-RING, (6mm X 1)	X
5	1	39051081	O-RING, (26mm X 2)	X
6	2	39051087	O-RING, (4mm X 3)	X
7	1	39053040	SEAL, WIPER, SNAP IN, WED, 12, 94A, AU	X
8	1	39056000	SEAL, STEP, ROD, 12	X
9	1	39056011	SEAL, CAP, PISTON, 25, 94A, AU	X
10	2	43068004	PLUG, SOCH, G1/8	
11	1	81400151	CAP, LC/SC, 7MPa, 25B	
12	2	81400200	PLUG, MANIFOLD, 7MPa, M6	
13	1	81600140	PLUNGER, LC, 7MPa, 25B	
14	2	81600145	LINK, LC, 7MPa, 25B	
15	2	81600150	PIN, LINK, LC, 7MPa, 25B	
16	1	81600155	PIN, PLUNGER, LC, 7MPa, 25B	
N/A	N/A	L6016250	KIT, SEAL, LC, 7MPa, 25B	NOTED

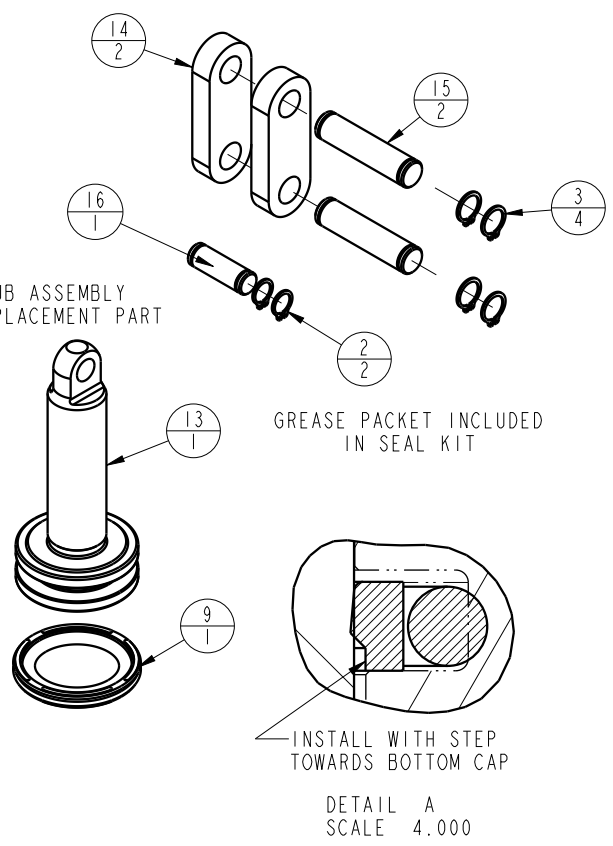
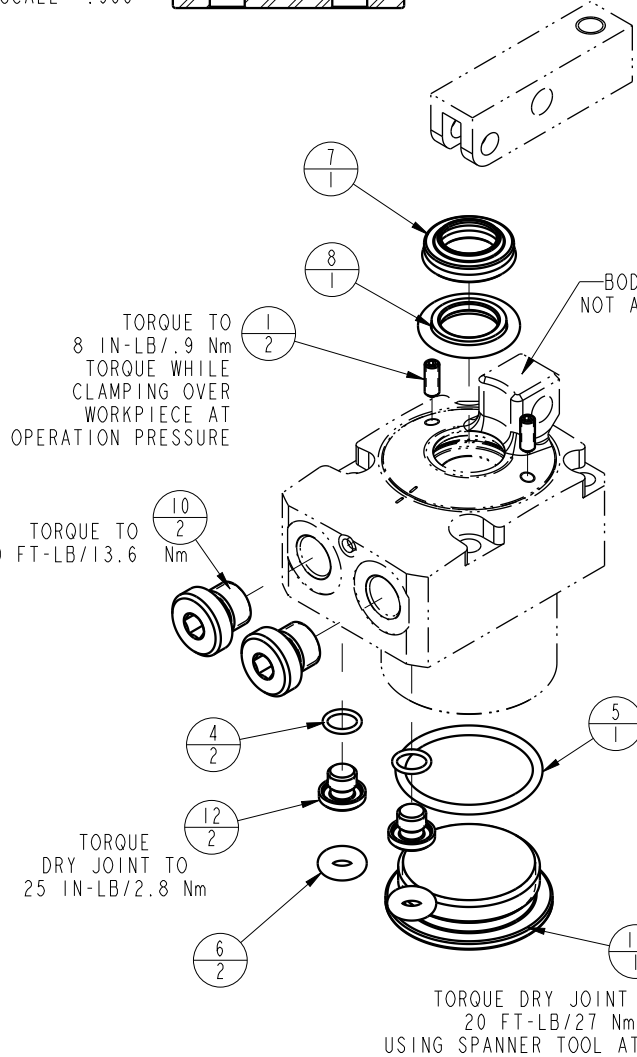

PARTS LIST		
	VEKTEK, INC. 1334 E. SIXTH AVE. P.O. BOX 625 EMPORIA, KS. 66801 U.S.A.	
	ASSEMBLIES AFFECTED	PARTS LIST, ASSY, LC, 7MPa, 25B
	L1602500	ROTARY LUG
SIZE	LPL1600	REV
A		C

C	3273	RELEASE	JDW	08/15/18
REV	IN ACCORDANCE WITH ECN	EFFECTIVE DATE	REVISED BY	DATE
DRW BY:	OMITCHELL	DRAWING STATUS: Released		
DATE:	7-16-13	PRODUCTION APPROVED FOR RELEASED STATUS ONLY		